

Sold



142 Templewood Crescent, Avondale Heights



MAGNIFICENT FAMILY LIVING!

Situated in an exclusive and sought after location, only walking distance to all local amenities and surrounded by huge homes is this architecturally designed family home that delivers a spacious floorplan for the growing family.

Proudly maintained and cherished by original owners, A well-planned layout consists of a large entry hall, 4 large bedrooms (all with BIR & main with ensuite & WIR), formal lounge with cathedral ceilings, elegant dining room, large timber kitchen with family sized meals area, rear rumpus room, central fully tiled spa bathroom, 3 toilets, separate study, double r/c garage with internal access, plenty of storage throughout the home and a backyard full of lush greenery that you can enjoy year round.

Highlights include ducted heating & evaporative cooling, solar panels, intercom, alarm system, electric roller shutters and much more.

Ideally positioned near St Martin De Porres School & nearby to quality secondary schools, local cafes, shops, buses, parks and Highpoint.

4 Beds 2 Baths 2 Cars

Price	SOLD
Property Type	Residential
Property ID	1636

Agent Details

David Gigliotti - +61411824854

Office Details

Avondale Heights
151 Military Road Avondale
Heights VIC 3034 Australia
03 9337 5066

A true family haven in a premiere location!

DAVID GIGLIOTTI - 0411 824 854

The above information provided has been furnished to us by the vendor/s. We have not verified whether or not that information is accurate and do not have any belief in one way or the other in its accuracy. We do not accept any responsibility to any person for its accuracy and do no more than pass it on. All interested parties should make and rely upon their own inquiries in order to determine whether or not this information is in fact accurate.

142 Templewood Crescent, AVONDALE HEIGHTS

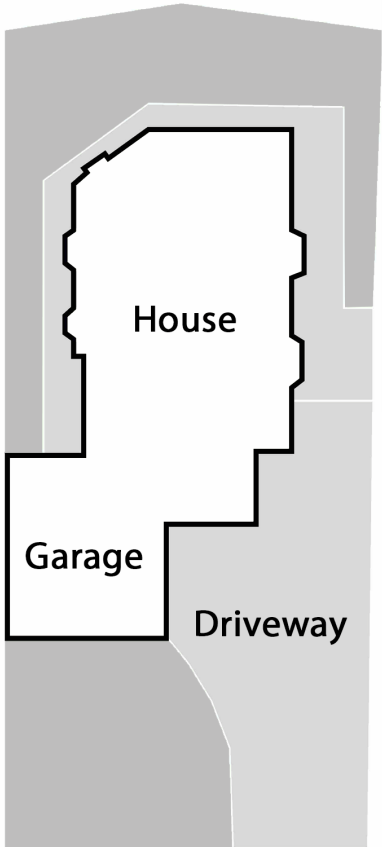
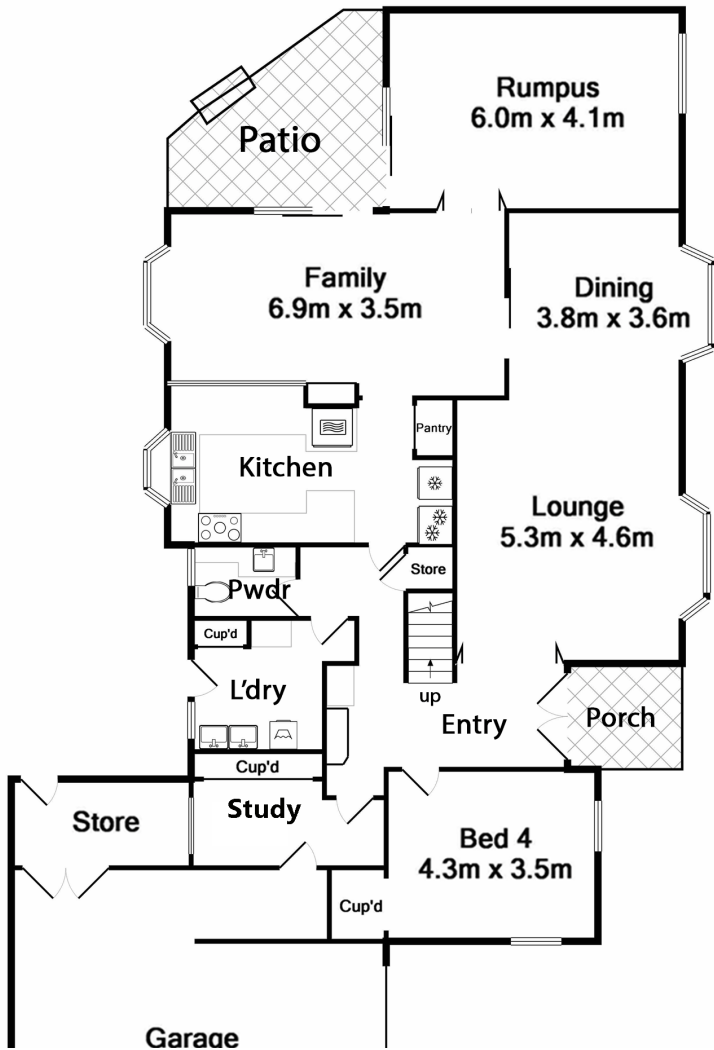

Site Plan

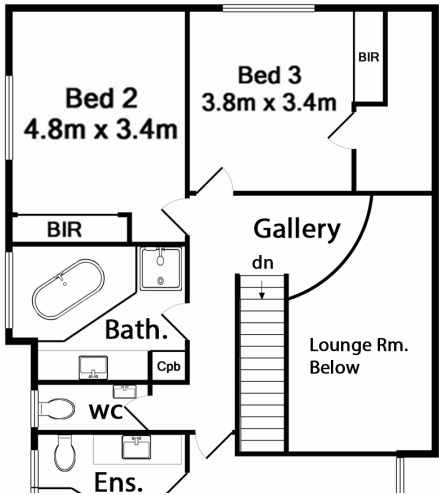

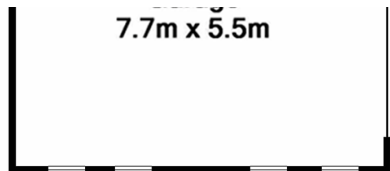

Ground Floor

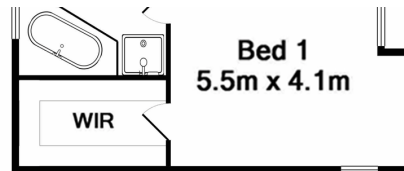

First Floor

Whilst every attempt has been made to ensure the accuracy of the floor plan contained here, measurements of doors, windows, rooms and any other items are approximate and no responsibility is taken for any error, omission, or mis-statement. This plan is for illustrative purposes only and should be used as such by any prospective purchaser. The services, systems and appliances shown have not been tested and no guarantee as to their operability or efficiency can be given.